

notes :

- If this drawing has been received electronically it is the recipient's responsibility to print the document to the correct scale.
- All dimensions are in millimetres unless stated otherwise. It is recommended that information is not scaled off this drawing.
- This drawing should be read in conjunction with all other relevant drawings and specifications.

Key:

- : Denotes proposed levels.
- : Denotes perimeter tie in level (not to be altered).
- : Denotes existing levels.
- 3.816 : Denotes roundabout tie in level. These levels must not be adjusted as they are set by the design requirements for the new access road.
- : Denotes retaining wall constructed as part of enabling works.
- : Denotes retaining wall - main contract.
- : Denotes site boundary.

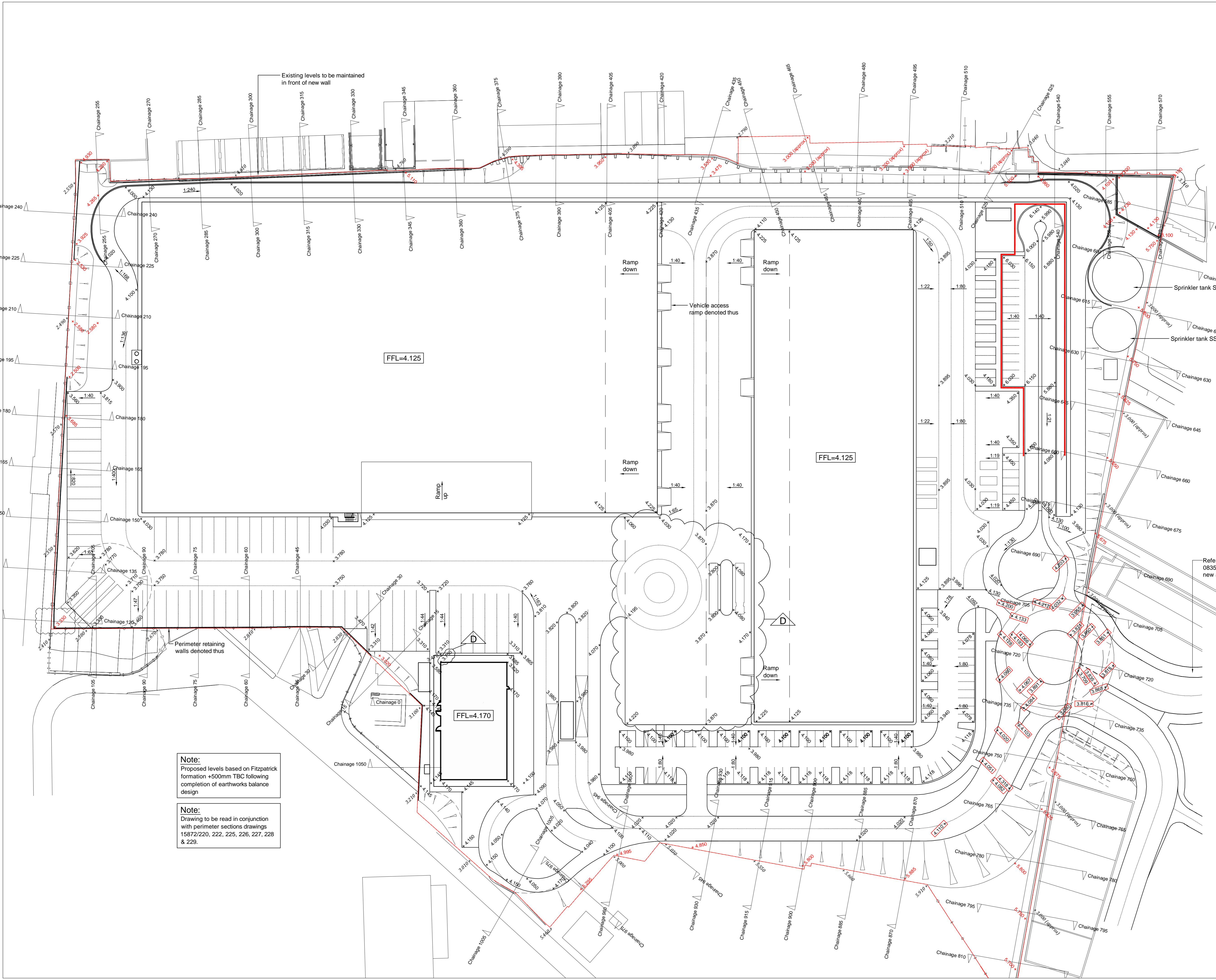

Refer to drawings 15872-0801, 0835 & 0875 for roundabout & new access road details.

D	Levels amended to suit new layout.	AKC	ST	07/05/09
C	Levels and walls around Resources Centre updated. Western boundary topography added. General updates.	AKC	RM	21/04/09
B	Roundabout layout updated and levels confirmed, extent of retaining wall around HWRRR road amended.	AKC	RM	25/02/09
A	General updates, retaining walls indicated. Ramps at level access doors added, perimeter levels indicated in red text, new roundabout levels noted in abeyance.	ST	ST	10.02.09

rev	amendments	by	cd	date



Sherwood House  
 Sherwood Avenue  
 Newark, Nottinghamshire  
 NG24 1QQ

T +44 (0) 1636 605 700  
 F +44 (0) 1636 610 696  
 W www.rpsgroup.com  
 E rpsnewark@rpsgroup.com



Client  
 Project Southwark MBT/MRF

Title Proposed Finished Levels

Drawing Status Preliminary Date Created 27.01.09 Drawing Scale 1:500  
 Project Leader AWY Drawn By LM Initial Review TD

Drawing Number 15872 / A1 / 0600 Rev D